

A1010 T P X - 2 X- X

代码+间距 T示意端子 X普通脚
H高脚 P磷铜 0基材
B黄铜 2镀锡先冲后镀
E合金铜 3镀锡先镀后冲
4镀全镍(镀后冲)
5. 2镀全镍先冲后镀
56、156示意镀金5U"或15U", 16示意镀金1U"

X公端
G母端
C示意90°
S示意180°

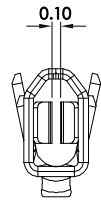
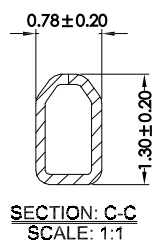
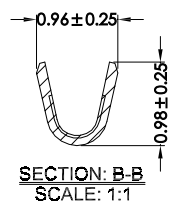
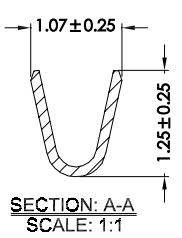

- Specifications :
- Voltage rating: 50V AC / DC
 - Current rating: 1A AC / DC
 - Withstanding voltage: 250V AC/minute
 - Temperature range: -25°C~+85°C
 - Insulation resistance: ≥100MΩ
 - Contact resistance: ≤20mΩ
 - After environmental testing: ≤40mΩ

东莞市平达电子科技有限公司

		料号PART NO: A1010TPX-2X-G 品		一般公差 GENERAL TOLERANCE	
		名 TITLE:		X. X ±0.30	
		材料: C5191		X. XX ±0.20	
		单位: MM		ANGLE ±1°	
日期版次 REVISION		日期 DATE		日期: 2022/02/22	
变更内容 DESCRIPTION		核 准 APPROVALBY		比例: 1:1	
		核 准 制 图:		包 装 规 格:	
		审 核:		核 准:	

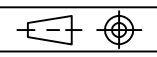

SL