

SPECIFICATIONS

- Voltage rating: 125V AC/DC;
- Current rating: 1A AC/DC;
- Withstanding Voltage: 250V AC/minute
- Insulation resistance: 100MΩ Min
- Temperature range: -40°C~+85°C
- Contact resistance: 20mΩ Max
- Conductor size: AWG28~#32

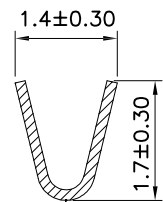

SECTION A-A

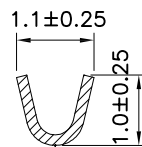

SECTION B-B

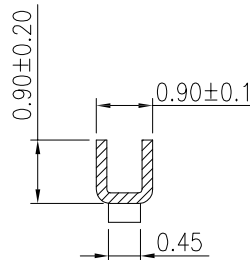

SECTION C-C

A1250 T P X - 2 X - X

- 代码+间距
- T示意端子
- P磷铜
- B黄铜
- E合金铜
- X普通脚
- H高脚
- X公端
- G母端
- X普通 C示意90°
- L长 S示意180°
- 0素材
- 2镀锡先冲后镀
- 3镀锡先镀后冲
- 5G、15G示意镀金5U"或15U", 1G示意镀金

东莞市平达电子科技有限公司

				料号PART NO: A1250TPX-2X-X				一般公差 GENERAL TOLERANCE	
				品名 TITLE: MX1.25-T公				X.X ±0.25	
				材料: C5191		单位: MM		X.XX ±0.20	
				日期版次 REVISION		日期 DATE		ANGLE ±1°	
				变更内容 DESCRIPTION		核 准 APPROVALBY		制图: 审核: 批准: 日期: 2022. 4. 14	

